

# COMMERCIAL REAL ESTATE SERVICES

## INVESTMENT SALES AND LEASING

**BERKSHIRE  
HATHAWAY**  
HOMESERVICES

RW TOWNE  
REALTY

COMMERCIAL DIVISION



## KEY FEATURES

- ± 11,616 SF Building
- ± 0.82 AC
- Zoned B-3 in Henrico County
- Excellent visibility
- Two level interior showroom, office, storage room and two restrooms
- Dock-level loading area and wide overhead door
- Pylon signage with message board and signage permitted on 4 sides

FREESTANDING RETAIL

FOR SALE | LEASE

## NOW AVAILABLE

**7252-7256 West Broad Street | Richmond VA 23294**

Great opportunity to locate on heavily traveled W Broad Street between Glenside Drive and E Parham Road with convenient access to I-64.



**To Learn More, Contact:**

**JANET MOORE, CCIM**

janet.moore@rwtowne.com

757.645.4500

janetmooreccim.com

4135 Ironbound Road, Williamsburg, VA 23188 | janetmooreccim.com | 757.645.4500

# COMMERCIAL REAL ESTATE SERVICES

## INVESTMENT SALES AND LEASING

**BERKSHIRE  
HATHAWAY**  
HOMESERVICES

RW TOWNE  
REALTY

COMMERCIAL DIVISION

FREESTANDING RETAIL

FOR SALE | LEASE



Interior with Large Storefront Windows



Private Offices and Sales Counter



## DEMOGRAPHICS

	1 MI	3 MI	5 MI
POPULATION	10,427	95,197	227,531
HOUSEHOLDS	4,181	40,693	98,208
AVERAGE HOUSEHOLD INCOME	\$58,566	\$74,926	\$82,204
DAYTIME POPULATION	18,003	122,871	260,239

# COMMERCIAL REAL ESTATE SERVICES

## INVESTMENT SALES AND LEASING

**BERKSHIRE  
HATHAWAY**  
HOMESERVICES

RW TOWNE  
REALTY

COMMERCIAL DIVISION

FREESTANDING RETAIL

FOR SALE | LEASE

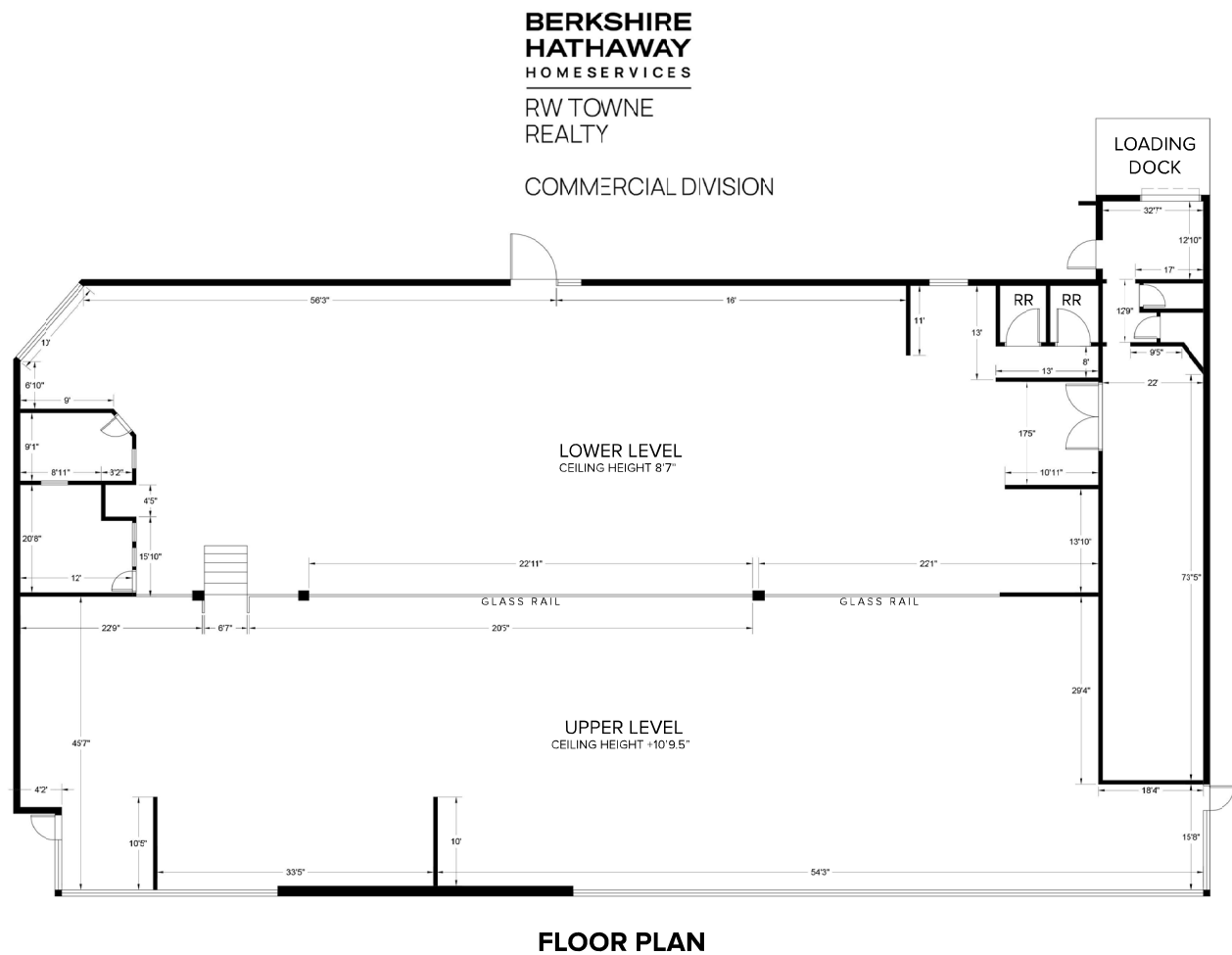

This floor plan including furniture, fixture measurements and dimensions are approximate and for illustrative purposes only. BoxBrownie.com gives no guarantee, warranty or representation as to the accuracy and layout. All enquiries must be directed to the agent, vendor or party representing this floor plan.

**7252 W Broad Street Richmond VA 23294**

# COMMERCIAL REAL ESTATE SERVICES INVESTMENT SALES AND LEASING

**BERKSHIRE  
HATHAWAY**  
HOMESERVICES

RW TOWNE  
REALTY

COMMERCIAL DIVISION

FREESTANDING RETAIL

FOR SALE | LEASE



## LOCATION FEATURES

- 108' of frontage
- Good ingress/egress (E/W)
- ± 0.50 mile to I-64
- ± 1.5 miles west of the redeveloped Willow Lawn retail hub
- 33,000 VPD

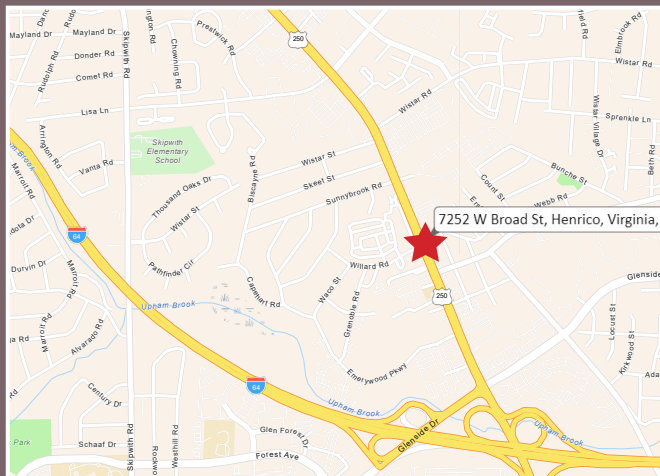

4135 Ironbound Road, Williamsburg, VA 23188 | Office: 757.220.9500



No warranty or representation, express or implied, is made to the accuracy or completeness of the information contained herein, and same is submitted subject to errors, omissions, change of price, rental or other conditions, withdrawal without notice, and to any listing conditions imposed by the property owner (s). As applicable we make no representation as to the condition of the property (or properties) in question. I Exclusive Agent Representing the Seller. All information is believed to be accurate but is not warranted and is solely a guide to prospective purchasers who should satisfy themselves by inspection or otherwise as to the correctness of this information. ©2024 BHH Affiliates, LLC. An independently owned and operated franchisee of BHH Affiliates, LLC. Berkshire Hathaway HomeServices and the Berkshire Hathaway HomeServices symbol are registered service marks of Columbia Insurance Company, a Berkshire Hathaway affiliate. Equal Housing Opportunity. Berkshire Hathaway HomeServices RW Towne Realty is an affiliate of TowneBank and licensed in the states of Virginia and North Carolina.